

For Office Use: 12364

PROJECT ADDRESS :

3RD FLOOR
 20 ST ANN'S SQUARE
 MANCHESTER
 M2 7HQ

CLIENT :



DRAWN BY:

RJS

ISSUE / DATE:

LISTED BUILDING APP 15.04.2019

REVISION :

INFORMATION ADDED 17.05.2019

LAYOUT AMENDED 19.08.2019

SHEET TITLE :

PROPOSED THIRD FLOOR PLAN

SHEET NO. :

PL103

NOTES & METHOD STATEMENT:

ALL EXISTING TIMBER SASH WINDOW TO REMAIN AND BE REPAIRED WHERE NECESSARY USING MATCHING TIMBER AND/OR SUITABLE TIMBER FILLER. RUBBED DOWN BY HAND USING SUITABLE GRADE SANDPAPER. PRIMED AND REDECORATED WITH 2NO. FULL COATS OF GLOSS PAINT.

ALL EXISTING SANITARYWARE AND ASSOCIATED PIPEWORK TO BE REMOVED.
 NEW SANITARYWARE TO BE INSTALLED TO MANUFACTURERS DETAILS USING SUITABLE FIXING BOLTS AND SCREWS.

ALL EXISTING FLOOR FINISHES TO BE REMOVED. EXISTING BOARDED SUBSTRATE TO BE REPAIRED WHERE NECESSARY WITH MATCHING BOARDS SCREWED INTO EXISTING FLOOR JOISTS. NEW CARPET TILES TO BE LAID USING SUITABLE ADHESIVE AS RECOMMENDED BY THE MANUFACTURER. CERAMIC TILING TO BE LAID ON SUITABLE ADHESIVE AND FINISHED WITH FLEXIBLE GROUT.

ALL EXISTING WOOD CHIP WALLPAPER TO BE STRIPPED OFF USING STEAMERS AND HAND SCRAPERS BACK TO UNDERLYING PLASTER SUBSTRATE. WALLS, COLUMNS AND DOWNSTANDS PATCH REPAIRED/SKIMMED WITH NEW PLASTER WHERE NECESSARY AND REDECORATED WITH MIST COAT AND 2NO. FULL COATS OF EMULSION PAINT.
 NEW WC'S TO BE FULLY TILED WITH CERAMIC TILING ADHERED TO NEW AND EXISTING WALLS USING SUITABLE ADHESIVE AND FINISHED WITH FLEXIBLE GROUT.

ALL EXISTING PLASTER CORNICING TO REMAIN AND BE RUBBED BACK BY HAND USING SUITABLE GRADE SANDPAPER, REPAIRED WHERE NECESSARY AND REDECORATED WITH MIST COAT AND 2NO. FULL COATS OF EMULSION PAINT.

ALL EXISTING TIMBER MOULDINGS INCLUDING ARCHITRAVES AND SKIRTING TO REMAIN AND BE STRIPPED BACK BY HAND USING SUITABLE GRADE SANDPAPER, PRIMED AND REDECORATED WITH 2NO. FULL COATS OF GLOSS PAINT.

EXISTING EXPOSED SECTION OF ROOF TO BE INSULATED WITH RIGID PIR TYPE INSULATION FITTED BETWEEN EXISTING ROOF RAFTERS AND FINISHED INTERNALLY WITH 15MM GYPROC WALLBOARD SCREWED TO UNDERSIDE OF RAFTERS, SEALESS JOINTED AND DECORATED WITH MIST COAT AND 2NO. FULL COATS OF EMULSION PAINT.

- HIGH SIGNIFICANCE (ORIGINAL)
- CONSIDERABLE SIGNIFICANCE (HISTORIC)
- NO SIGNIFICANCE (NON ORIGINAL OR HISTORIC)

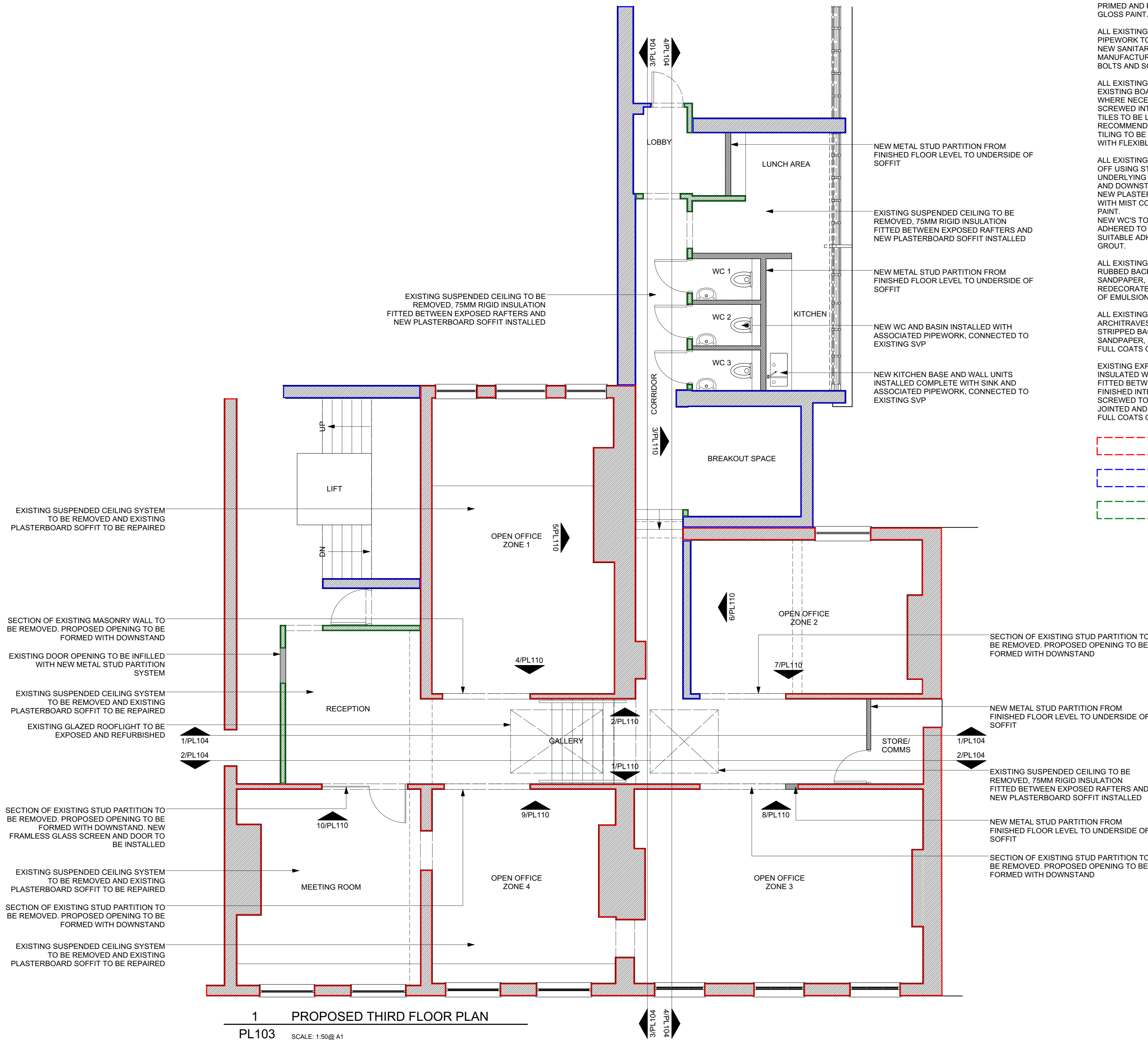

1 PROPOSED THIRD FLOOR PLAN
 PL103 SCALE: 1:50@A1

